

Bridge Views

KNOWLE WEST

APPROXIMATE FLOOR AREA
111.4 SQM / 1199 SQFT



GROUND FLOOR

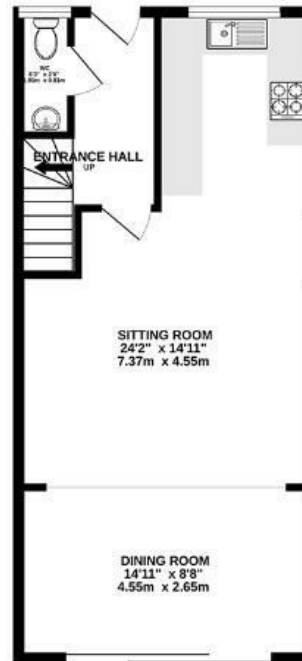

FIRST FLOOR

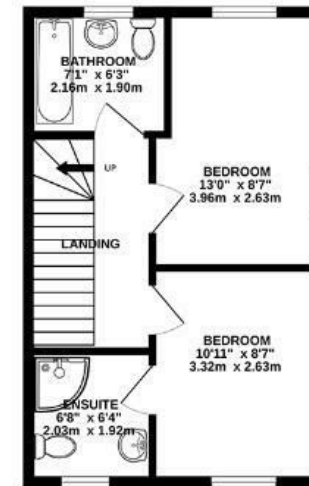

SECOND FLOOR

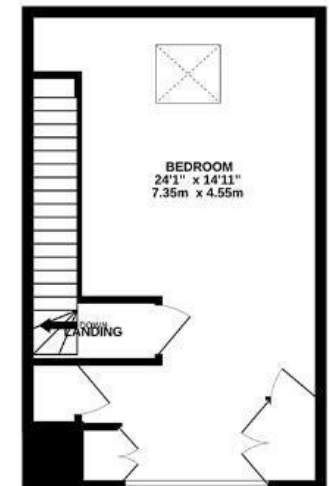

Boardwalk

Bridge Views

KNOWLE WEST, BRISTOL



£350,000



BS4 1EU



3 Bedrooms



3 Bathrooms

"It's the perfect location for commuting into town - just a 40-minute walk, close to bus stops, and a stone's throw from Parson Street train station. We've loved eating and drinking along North Street and in Bedminster. Living here has always felt safe, and we have a lovely relationship with several of our neighbours. There are children the same age as ours, and when the weather is nice, they all play together on their scooters and bikes out front on the private road. It's a peaceful spot with no noise from any main roads."

